

# Scrabble

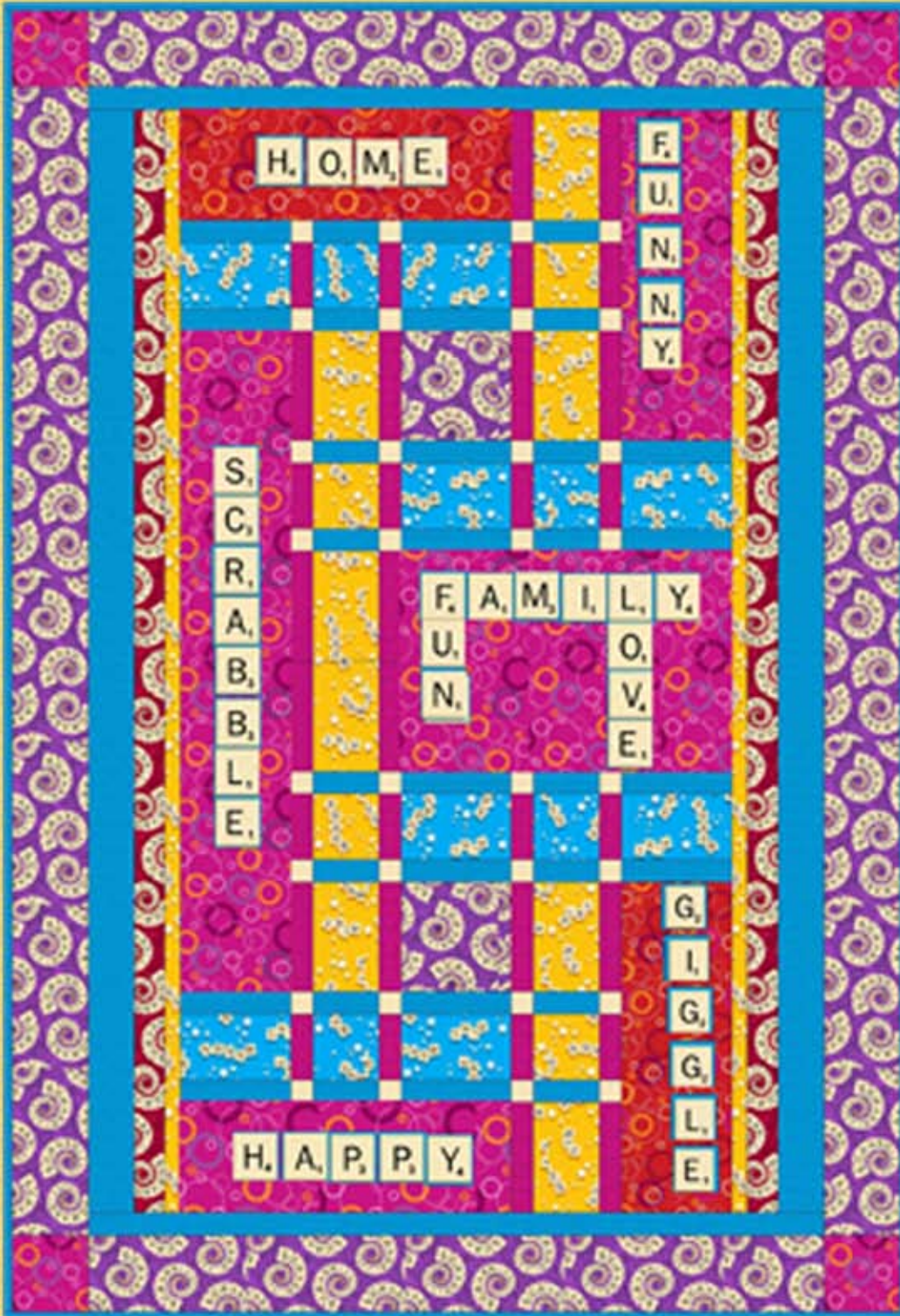

Approximate Finished Quilt Size: 61" x 88"

©2010Hasbro™, All Rights Reserved

[www.QuiltingTreasures.com](http://www.QuiltingTreasures.com)

# Scrabble

Finished Quilt Size: 61" x 88"  
Designed by Pat Harrison

## Materials for the Quilt



21213B  
Scrabble Squares



21214R  
Red Scrabble Print



21214V  
Violet Scrabble Quilt



21215B  
Blue Letter Print



21215S  
Yellow Letter Print



21218B  
Blue Tonal



21218E  
Cream Tonal



21218V  
Violet Tonal



21219OR  
Orange Circle Print



21219V  
Violet Circle Print



21220V  
Scrabble Board Print

You will also need:  
Lightweight,  
double-sided,  
fusible webbing  
Thread for machine  
appliqué of  
printed letter  
squares

### Yardage Requirements

21213B	2/3 yard OR 1 panel OR sufficient yardage for letters to make desired words
21214R	3/8 yard
21214V	1 5/8 yards
21215B	1/2 yard
21215S	5/8 yard
21218B	1 1/2 yards (includes binding)
21218E	1/4 yard
21218V	1/2 yard
21219OR	5/8 yard
21219V	1 5/8 yards
21220V	5 1/2 yards (for Quilt Backing)

## Cutting

**NOTE: WOF equals width of fabric from selvage edge to selvage edge.**

- 21213B** Fussy cut letter tiles into 3" squares for raw edge appliqué forming words to be placed on top of circle print pieces. Examples: games, funny, scrabble, laughter, giggle, family.
- 21214R** Cut 4 - 2½" strips WOF for side inner border #2.
- 21214V** Cut 1 - 7¾" strip WOF, subcut into 2-7¾" squares.  
Cut 7 - 6½" strips for outer border #2.
- 21215B** Cut 2 - 4⅞" strips on WOF. Subcut into 8- 4⅞" x 7¾" rectangles and 4-4⅞" squares.
- 21215S** Cut 2 - 4⅞" strips WOF. Subcut into 8- 4⅞" x 7¾" rectangles and 4- 4⅞" squares.  
Cut 4 - 1¾" strips WOF for side inner border #1.
- 21218B** Cut 4 - 2" strips WOF for lattice strips, subcut into 16-7¾" long pieces.  
Cut 2 - 2" strips WOF for lattice strips, subcut into 16-4⅞" long pieces.  
Cut 3 - 2" strips WOF for top and bottom outer border #1.  
Cut 4 - 3½" strips WOF for side outer borders #1.  
Cut 8-2¼" strips WOF for binding.
- 21218E** Cut 2 - 2" strips WOF for lattice cornerstones, subcut into 32- 2" squares.
- 21218V** Cut 4 - 2" strips WOF for lattice strips, subcut into 16- 7¾" long pieces.  
Cut 2 - 2" strips WOF for lattice strips, subcut into 16- 4⅞" long pieces.
- 21219OR** Cut 2 - 7¾" strips WOF, subcut into 2-7¾" x 22⅜" rectangles for lattice blocks.
- 21219V** Cut 6 - 7¾" strips WOF, subcut into 6 - 7¾" x 22⅜" rectangles for lattice blocks.  
Cut 1 - 6 ½" strip WOF, subcut into 4 - 6½" x 6½" squares for outer border cornerstones.

## Sewing

**All seams are sewn with right sides together, raw edges even, and using 1/4" seam allowance.**

### MAKE THE LATTICE UNITS

1. Stitch 2" x 7 ¾" blue tonal pieces to each long side of a 4⅞" x 7 ¾" blue letter print piece.  
Repeat to make a total of eight units.

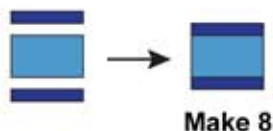

2. Arrange four 2" cream tonal squares, two 2" x 4⅞" blue tonal pieces, two 2" x 4⅞" violet tonal pieces, and one 4⅞" x 4⅞" blue letter print square into three rows with three units in each row as shown in Diagram 2. Stitch the units into rows and stitch the rows together. Repeat to make a total of four units.

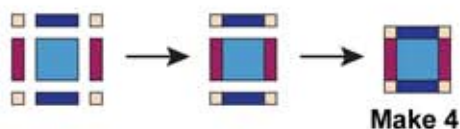

## Sewing (cont.)

3. Sew units from step 1 to each side of a unit from step 2, noting orientation. Repeat to make a total of four blue lattice units.



**Make 4**

4. Stitch 2" x 7 3/4" violet tonal pieces to each long side of a 4 7/8" x 7 3/4" yellow letter print piece. Repeat to make a total of eight units.

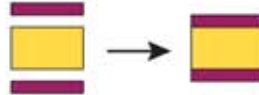

**Make 8**

5. Arrange four 2" cream tonal squares, two 2" x 4 7/8" blue tonal pieces, two 2" x 4 7/8" violet tonal pieces, and one 4 7/8" x 4 7/8" yellow letter print square into three rows with three units in each row as shown in Diagram 2. Stitch the units into rows and stitch the rows together. Repeat to make a total of four units.



**Make 4**

6. Sew units from step 1 to each side of a unit from step 2, noting orientation. Repeat to make a total of four yellow lattice units.



**Make 4**

## Quilt Assembly

1. Arrange two blue lattice units, two yellow lattice units, one 7 3/4" violet letter print square, three 7 3/4" x 22 3/8" violet circle print pieces, and one 7 3/4" x 22 3/8" orange circle print piece as shown in the diagram below. Stitch each lattice unit to a 7 3/4" x 22 3/8" circle print piece as shown. Finger press the violet letter print square in half to mark the center point on one side. Stitch the blue lattice and orange circle print unit to the violet print square with a partial seam starting at the center point and stitching in the direction shown by the shortest arrow on the diagram. Working clockwise, add each lattice unit to the center violet square as shown. To complete the top section assembly, secure the blue lattice and orange circle print unit to the other units by finishing the partial seam as shown.

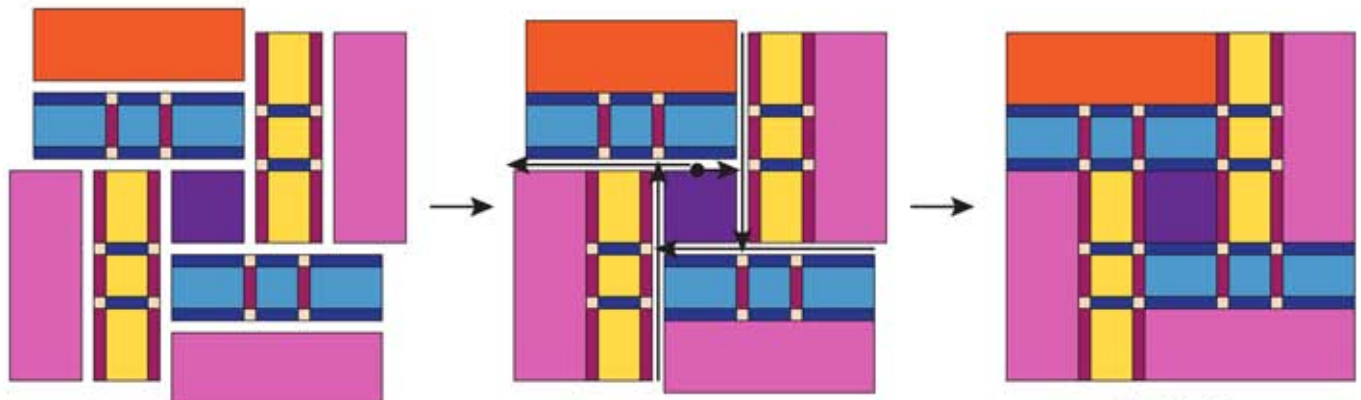

**Top Section**

## Quilt Assembly (cont.)

2. Repeat the procedure from step 1 to assemble the bottom section of the quilt top arranging the various units as shown below. Note that the partial seams in this section are worked in counter-clockwise order.

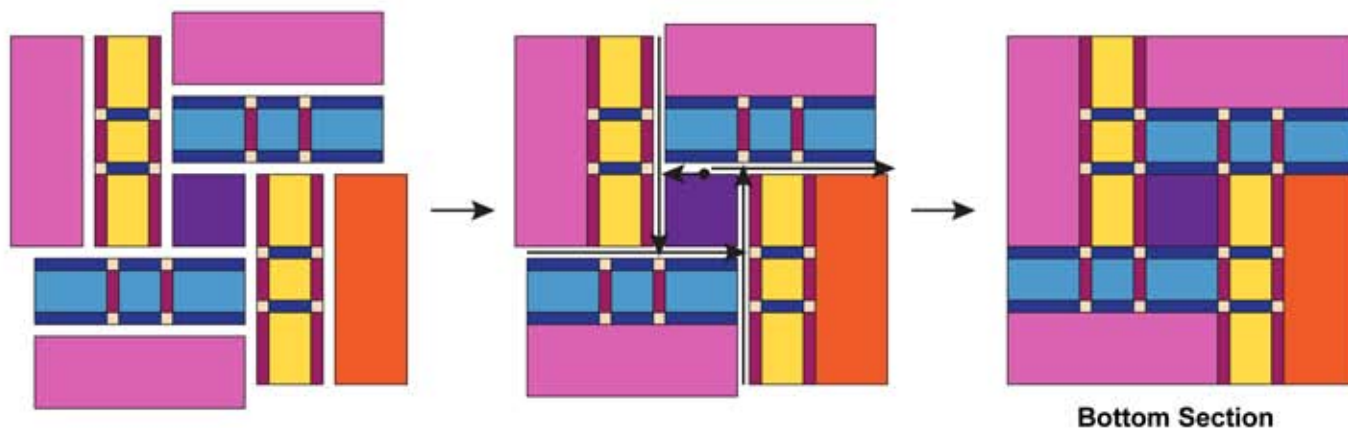

**NOTE:** Refer to the image of the finished quilt on the cover for steps 3-9.

3. Stitch the top section of the quilt to the bottom section, noting orientation of both units.
4. Cut the letters of your choice from the letter tiles panel, leaving a small margin around each letter. Following manufacturer's instructions, fuse lightweight, double-sided, fusible webbing to the wrong side of each letter. Trim each letter, remove the paper backing, and fuse it to the quilt top. Using the machine decorative stitch of your choice and coordinating thread, overcast the raw edges of each letter.
5. Trim the selvages from the 1  $\frac{3}{4}$ " yellow letter print strips and sew the strips together end to end to make a long 1  $\frac{3}{4}$ " strip. Cut two 73 $\frac{1}{2}$ " lengths from this strip (*if your measurements are different, cut to fit your quilt top*). Sew these lengths to the left and right sides of the quilt top.
6. Repeat the procedure from step 5 to add 73 $\frac{1}{2}$ " red letter print borders to the right and left sides of the quilt top.
7. Repeat the procedure from step 5 to add 73 $\frac{1}{2}$ " blue tonal borders to the right and left sides of the quilt top.
8. Repeat the procedure from step 5 to make a long 2" blue tonal strip. Cut two 49 $\frac{1}{2}$ " lengths from this strip (*if your measurements are different, cut to fit your quilt top*). Sew these lengths to the top and bottom of the quilt.
9. Repeat the procedure from step 5 to make a long 6 $\frac{1}{2}$ " violet letter print strip. From this long 6 $\frac{1}{2}$ " strip, cut two 76 $\frac{1}{2}$ " and two 49 $\frac{1}{2}$ " lengths (*if your measurements are different, cut to fit your quilt top*). Stitch the 76 $\frac{1}{2}$ " lengths to the left and right sides of the quilt top. Sew 6 $\frac{1}{2}$ " red circle print squares to each end of each 49 $\frac{1}{2}$ " long violet letter print piece. Sew these border units to the top and bottom of the quilt.
10. Layer the quilt top with batting and backing and quilt as desired.
11. Bind the finished quilt using the 2  $\frac{1}{4}$ " blue tonal strips.

**While all possible care has been taken to ensure the accuracy of this pattern, we are not responsible for printing errors or the way in which individual work varies.**